

RACK&PINION / DOUBLE ACTING / JD40~210

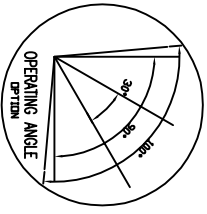

| REVISION | REVISION DESCRIPTION | DRAWN / DATE | RECHECKED / DATE | APPROVED / DATE |
|----------|----------------------|--------------|------------------|-----------------|
| △ | | | | |

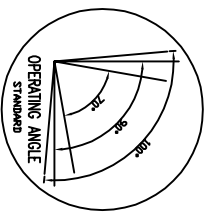
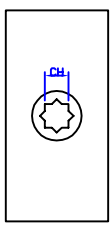
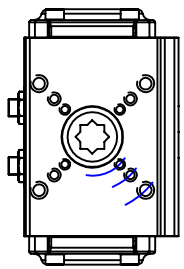
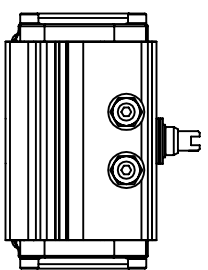
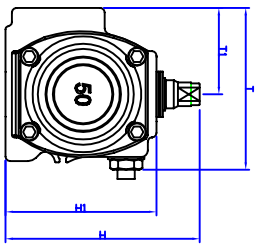
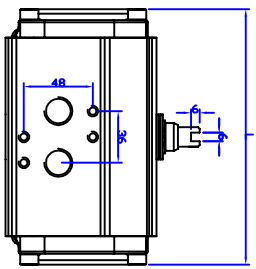
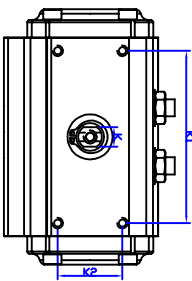

MAJOR PART LIST

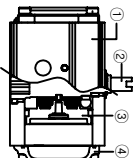

| NO. | PART NAME | MATERIAL |
|-----|-----------|------------------------------|
| 1 | BOB | ALUMINUM |
| 2 | SHAFT | STEEL ALLOY (NICKEL COATING) |
| 3 | PISTON | ALUMINUM |
| 4 | COVER | ALUMINUM |

SPECIFICATIONS

1. Operating fluid : Compressed dry air
2. Operating pressure : 4Bar~7Bar
3. Operating temperature : -20~80°

■ DIMENSION(mm)

| MODEL | K1 | K2 | ISO | φP.C.D | N-G | K | L | T | T1 | H | H1 | CH | DP | WEIGHT |
|--------|----|----|-------------|-------------|------------|----|-----|-----|------|-----|-----|-------|----|--------|
| JD-40 | 80 | 30 | F03/F05 | 36/50 | 4-M5/M6 | 9 | 97 | 63 | 32 | 75 | 55 | 9*9 | 9 | 0.6kg |
| JD-50 | 80 | 30 | F03/F05/F07 | 35/50/70 | 4-M5/M6/M8 | 10 | 119 | 75 | 40 | 90 | 70 | 11*11 | 13 | 1.6kg |
| JD-65 | 80 | 30 | F05/F07 | 50/70 | 4-M6/M8 | 13 | 131 | 89 | 46 | 107 | 87 | 14*14 | 14 | 2.7kg |
| JD-80 | 80 | 30 | F07 | 70 | 4-M8 | 17 | 189 | 101 | 49.5 | 126 | 106 | 17*17 | 17 | 4.3kg |
| JD-90 | 80 | 30 | F07/F10 | 70 | 4-M8 | 19 | 190 | 104 | 54.5 | 136 | 116 | 17*17 | 19 | 4.7kg |
| JD-100 | 80 | 30 | F07/F10 | 70/102 | 4-M8/M10 | 22 | 229 | 129 | 61.5 | 148 | 128 | 22*22 | 19 | 7.5kg |
| JD-125 | 80 | 30 | F07/F10 | 70/102 | 4-M8/M10 | 22 | 299 | 151 | 71.5 | 174 | 154 | 22*22 | 26 | 11.6kg |
| JD-140 | 80 | 30 | F10/F12 | 102/125 | 4-M10/M12 | 24 | 332 | 164 | 77 | 192 | 172 | 27*27 | 26 | 18.9kg |
| JD-160 | 80 | 30 | F10/F12/F14 | 102/125/140 | 4-M12/M16 | 32 | 364 | 188 | 89 | 216 | 196 | 36*36 | 30 | 26.3kg |
| JD-210 | 80 | 30 | F16 | 165 | 4-M20 | 9 | 444 | 231 | 115 | 284 | 254 | 46*46 | 60 | 47.2kg |

| | | | |
|------------------------------------|------------------|-------------------------|-----------|
| PRODUCT NAME Pneumatic actuator | | DRAWING NO. JD40-210 | |
| MODEL JD-40~JD210 | TITLE DRAWING | APPROVED DATE | REV. 1 |
| MATERIAL - | HARDNESS - | 제이애스밸브 | |